

How to Connect a Third Pump

Step 1: Having opened the main enclosure, use a flat headed screw driver to knock out the location and entry point for the third pump (shown right, marked with the X).

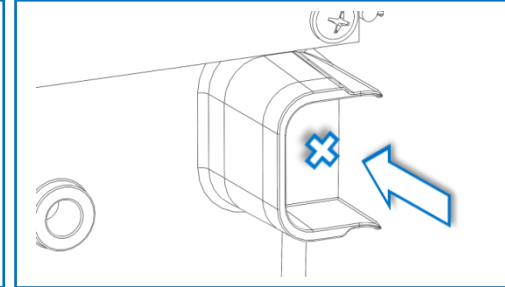

Step 2: Feed the connecting cable from the third pump through the knock out hole (a) and into the main unit. Then push together the two units making sure the locating pin at the top lines up with the receiving hole (b), push until they click together.

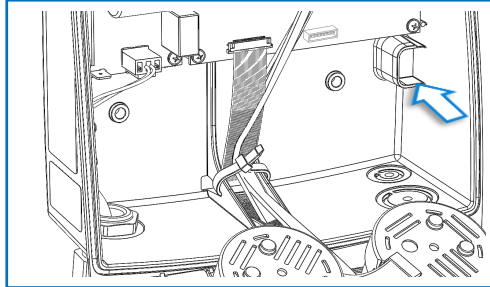
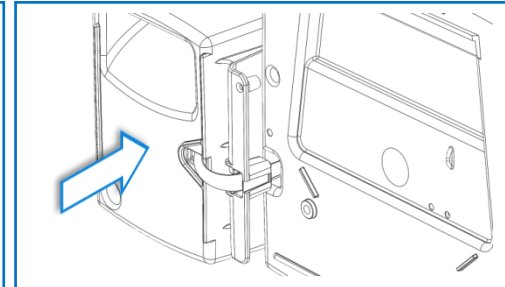
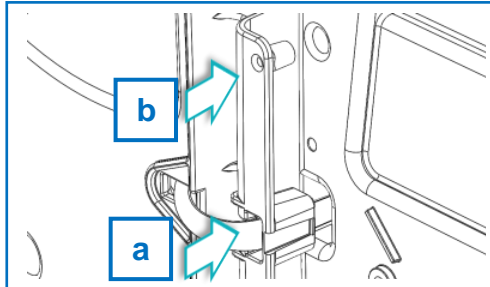

Step 3: Now connect this cable to the PCB board (shown right).

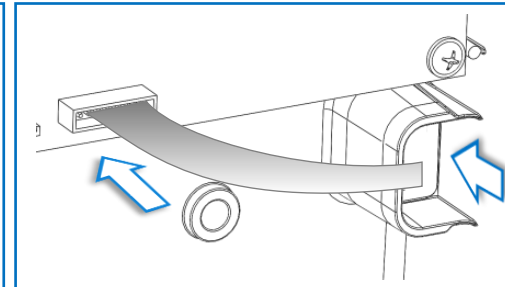
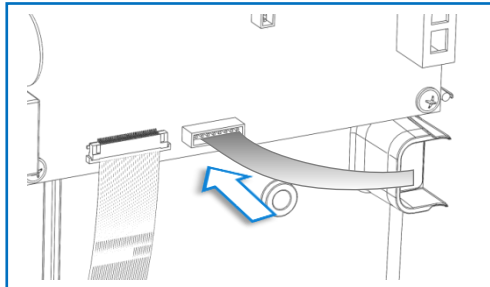

Operating: The third pump operates and functions in the same manner as the main unit (Q200) pumps. Settings for this pump's operation are applied in the same way as Pump 1 & 2 and can be seen in the menu (green sections) of the main manual. All Quantura user documentation can be found at www.brightwell.co.uk