

Installation Instruction

Sierra Pump Accessory Kit

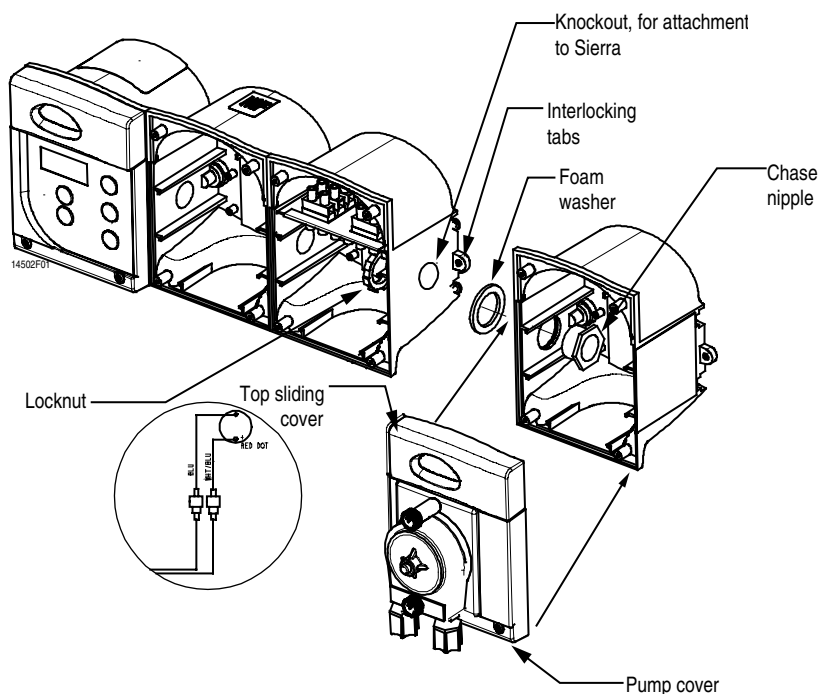
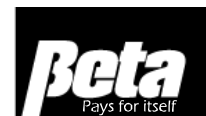

1. **TURN OFF** all power before opening unit.
2. When working with chemicals, wear adequate protective clothing such as gloves and safety goggles

To Attach to Sierra

1. Remove Sierra unit from wall.
2. Remove top sliding cover of Add-on pump box and rightmost Sierra pump box by inserting a small screwdriver under the right side of cover. Gently pry off, taking care not to damage the unit or cover.
3. Remove all four screws that hold the pump on the face of the unit.
4. Punch out right side knockout of rightmost Sierra pump box and left-side knockout of Add-on box by inserting a screwdriver into the slot, punching through the plastic. Rotate and twist the screwdriver to completely remove the knockout.
5. Remove adhesive liner from the foam washer and attach to the left side of the Add-on pump as required.

6. Fit the pump box into the right side of Sierra, aligning the interlocking tabs in the back.
7. Install chase nipple and locknut. Tighten to form proper seal.
8. Route the blue and white/blue wires from the Add-on pump box into Sierra through the knockout.
9. Attach Quick Disconnect connectors (not shown) from harness to blue wire (-) and the white/blue wire (+) of the Add-on pump.
10. Replace pump covers, reinstall screws and top sliding covers.

To Use As Stand-Alone Pump

1. Punch out knockout as required for wiring
2. Attach wiring using appropriate strain relief.
3. Use only 24 VDC to power the pump.



To comply with NSF regulations, sight glass must be used with Sierra sanitizer pumps.

