

DEMA BLEND CENTER

MODELS: 633GAP-1, 633GAPL-R4 & 633GAP-4

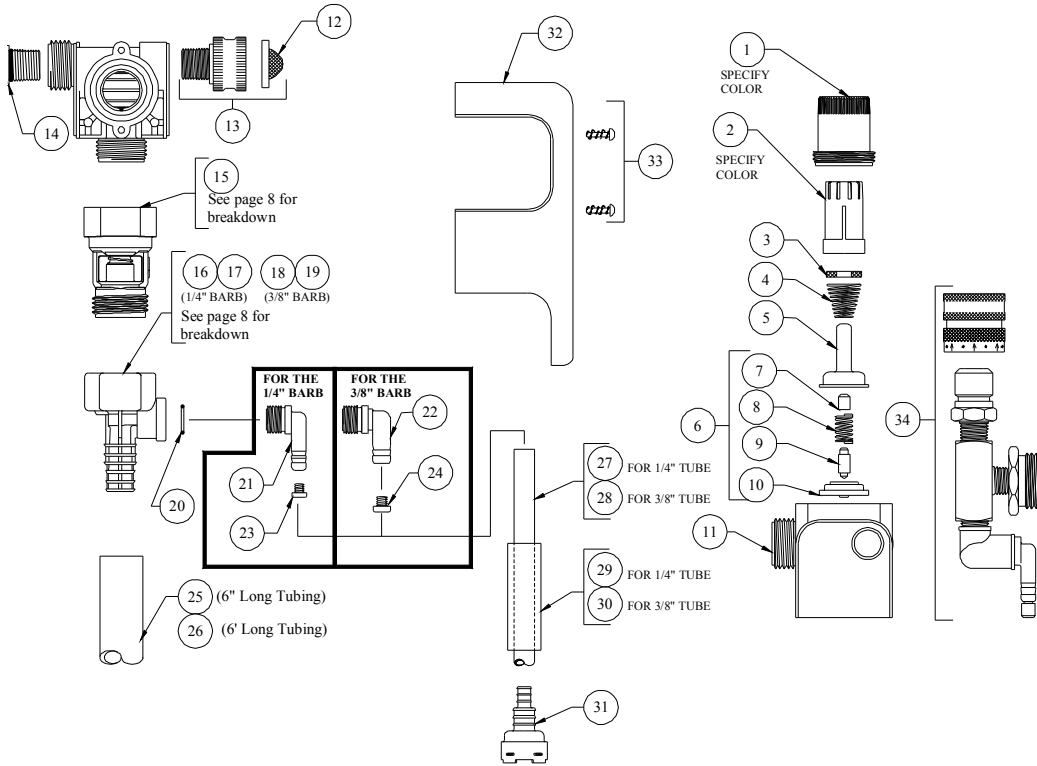

NO.	PART NO.	DESCRIPTION
1	66-139	Magnet Housing (Specify Color)
2	66-140	Push Button (Specify Color)
3	63-35	Magnet
4	63-36	Spring
5	41-7-25	Enclosing Tube
6	63-87	Valve Repair Kit
7	63-37	Spacer
8	41-1-8	Kick-off Spring
9	63-38	Plunger
10	41-15-5	Diaphragm
11	63-39	Valve Body
12	100-38	Strainer Washer
13	93-44	Swivel Adapter w/Strainer Washer
14	66-153	Pipe Plug & O-Ring Assy.
15	16-30	Action Gap Assembly
16	61-22-3	4 GPM (1/4" Barb) Prop. (Gray)
17	61-99-2	1 GPM (1/4" Barb) Prop. (Green)
18	61-22-2	4 GPM (3/8" Barb) Prop. (Gray)
19	61-99-1	1 GPM (3/8" Barb) Prop. (Green)
20	63-78	O-Ring

NO.	PART NO.	DESCRIPTION
21	63-79	Inlet Barb (1/4" Barb)
22	63-80	Inlet Barb (3/8" Barb)
23	100-15K	Metering Tip Kit (14 Sizes) (1/4" Barb)
24	61-9K	Metering Tip Kit (15 Sizes) (3/8" Barb)
25	16-3-6	1/2" ID X 6" Lg. Vinyl Outlet Tube (1 GPM Only)
26	61-21	1/2" ID X 6' Lg. Vinyl Outlet Tube (4 GPM Only)
27	100-12	1/4" ID X 8' Lg. Vinyl Supply Tubing
28	100-12L	3/8" ID X 8' Lg. Vinyl Supply Tubing
29	61-107-2	Ceramic Weight (3/8" OD Tube)
30	61-107	Ceramic Weight (1/2" OD Tube)
31*	100-16E	Foot Valve
32	63-45	Cover
33	63-46	Screws (2 Req'd)

ACCESSORIES		
NO.	PART NO.	DESCRIPTION
34	68-6-QD2	Pressure Indicating Tee

*Foot Valve also available with silicone (100-16S) or Viton (100-16V) rubber seals. Please specify material when ordering.